

LONG (LOON) LAKE LIVINGSTON COUNTY, MICHIGAN MAY 18TH, 2022 TREATMENT MAP

☐ = 1 ACRE

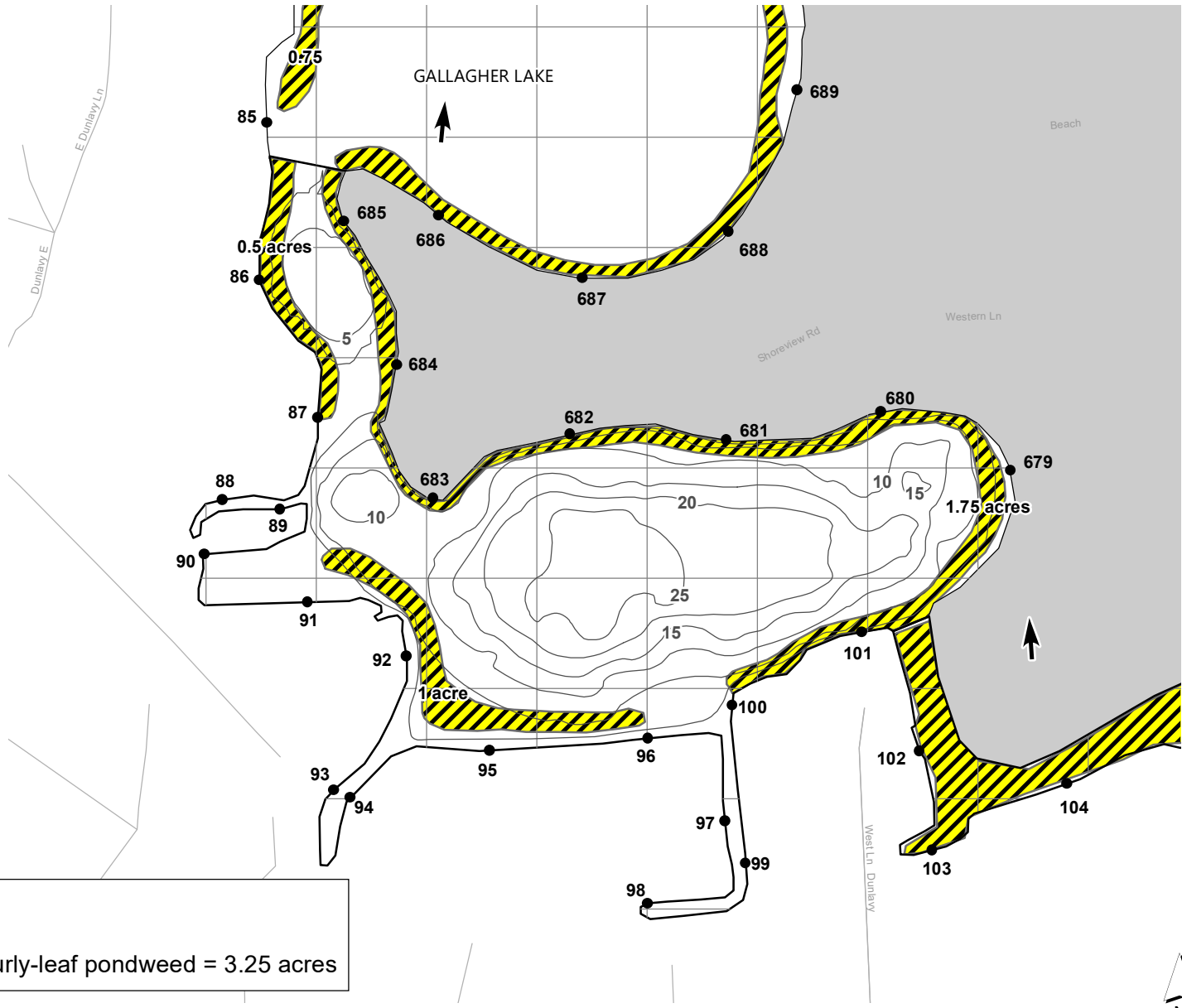

Treatment
 Clipper/Aquathol-K for curly-leaf pondweed = 3.25 acres

LAKE AREA = 17 ACRES
 REVISION DATE: FEBRUARY 2022

The applicator shall make adjustments, if needed, to comply with EGLE permit requirements.

