

PORTAGE LAKE NORTH PORTION LIVINGSTON COUNTY, MICHIGAN MAY 3, 2022 TREATMENT MAP

Treatment



Copper/Hydro 17.75 acres of starry stonewort
w/Cutrine Ultra/Hydrothol 191 tank mix



Diquat/Chelated Copper = 8 acres of curly-leaf
pondweed w/diquat-dibromide @ 1 gal acre w/
Cutrine Ultra or equivalent

**DIQUAT AND
CHELATED COPPER**

HONEY CREEK

**MATCH LINE
SOUTH PORTION**

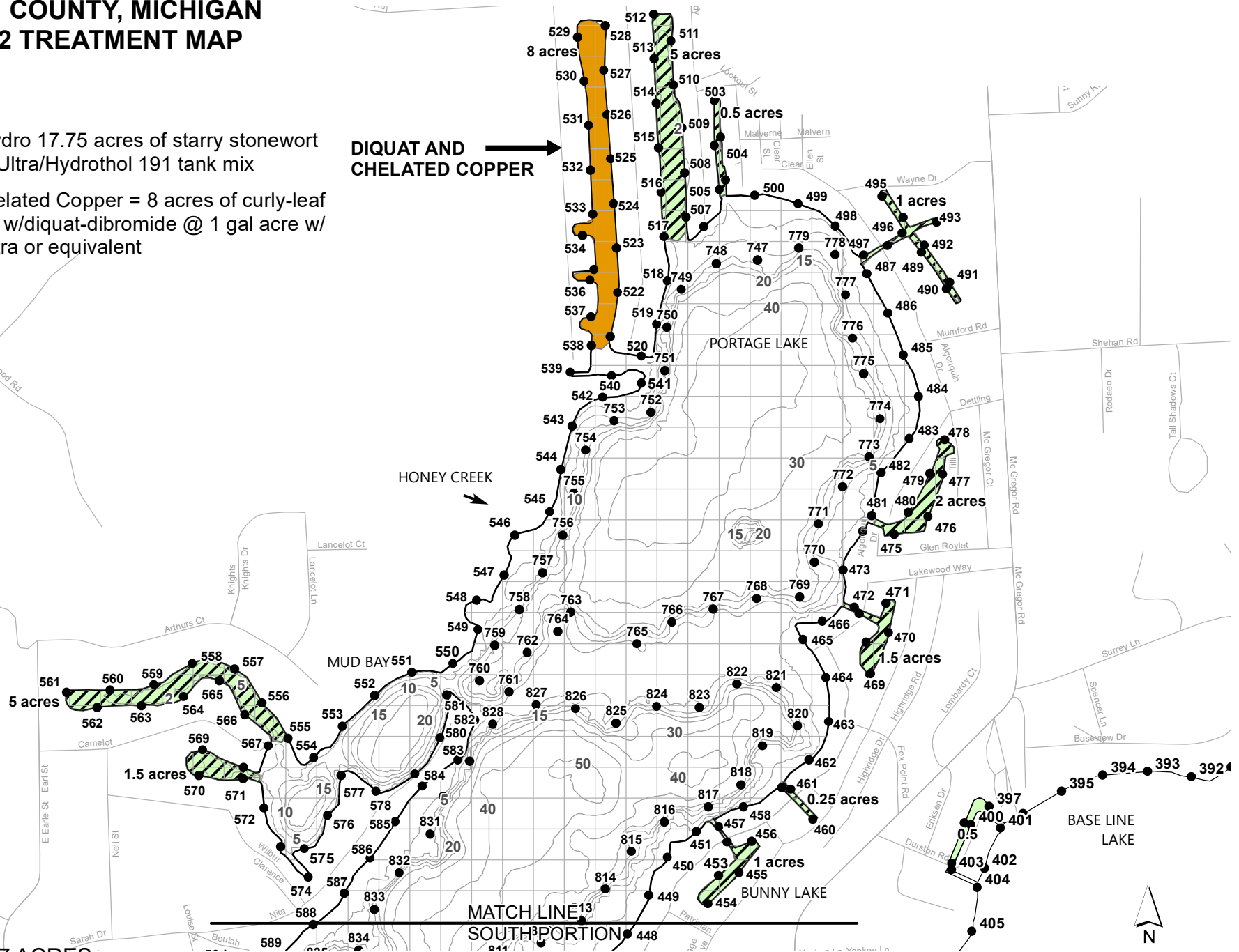

LAKE AREA: 657 ACRES

REVISION DATE: FEBRUARY 2022

The applicator shall make adjustments, if needed, to comply with EGLE permit requirements.

