



BASE LINE LAKE LIVINGSTON COUNTY, MICHIGAN AUGUST 10, 2020 TREATMENT MAP

Treatment

 2,4-D Ester = 0.5 acre of non-native milfoil w/Navigate @ 150 lbs./acre

 Copper/Hydro = 0.75 acre of stary stonewort w/CuSO4/Hydrothol 191

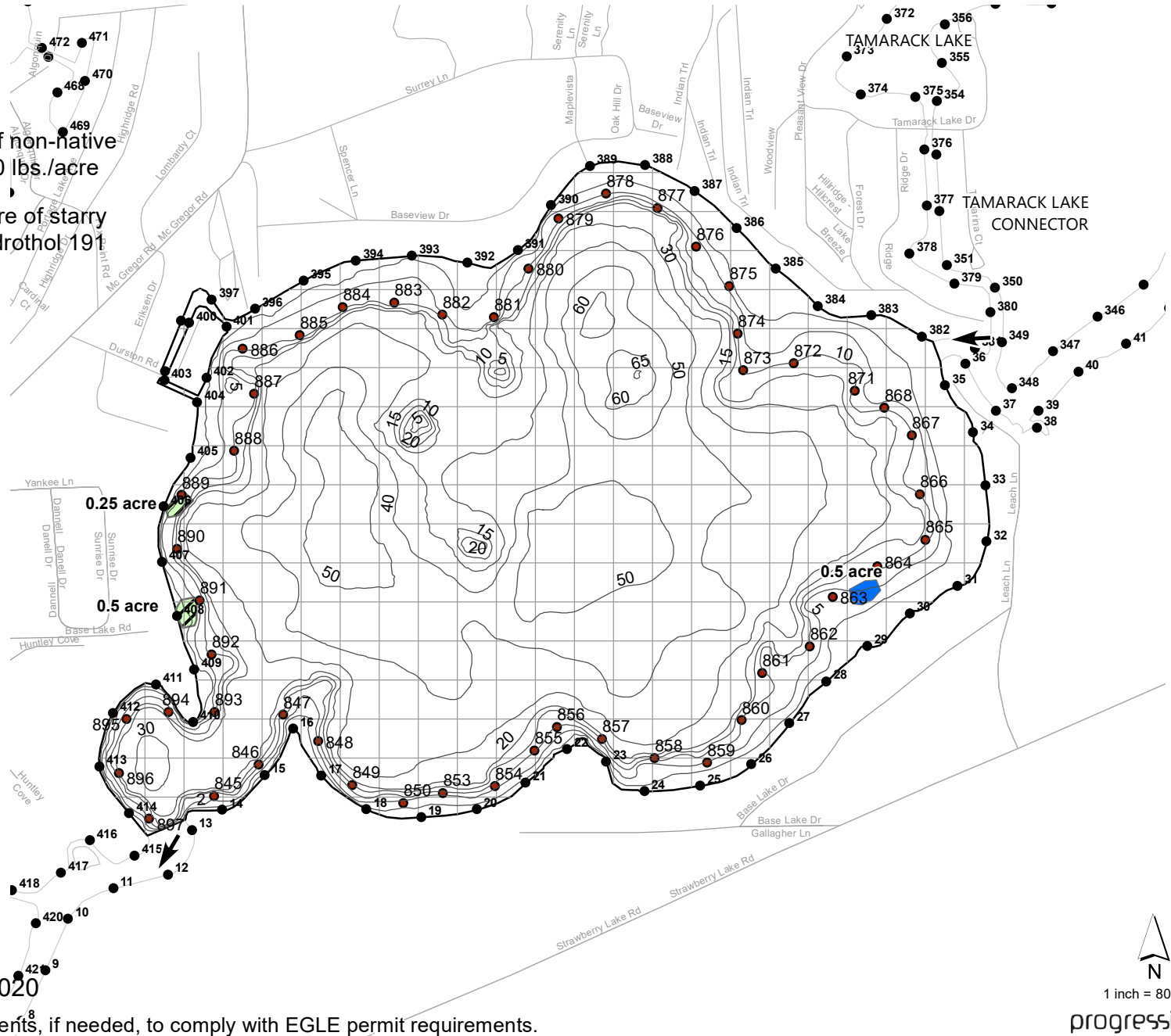

BASE-PORTAGE
CONNECTOR
LAKE AREA = 258 ACRES
REVISION DATE: MARCH 2020

The applicator shall make adjustments, if needed, to comply with EGLE permit requirements.