



LITTLE PORTAGE LAKE LIVINGSTON COUNTY, MICHIGAN JULY 6, 2020 TREATMENT MAP

Treatment

-  Algae = 0.5 acre of nuisance filamentous algae w/CuSO4
-  Copper/Hydro = 4.75 acres of starry stonewort w/CuSO4/Hydrothol 191
-  2,4-D Ester = 0.5 acre of non-native milfoil w/Navigate @ 150 lbs./acre

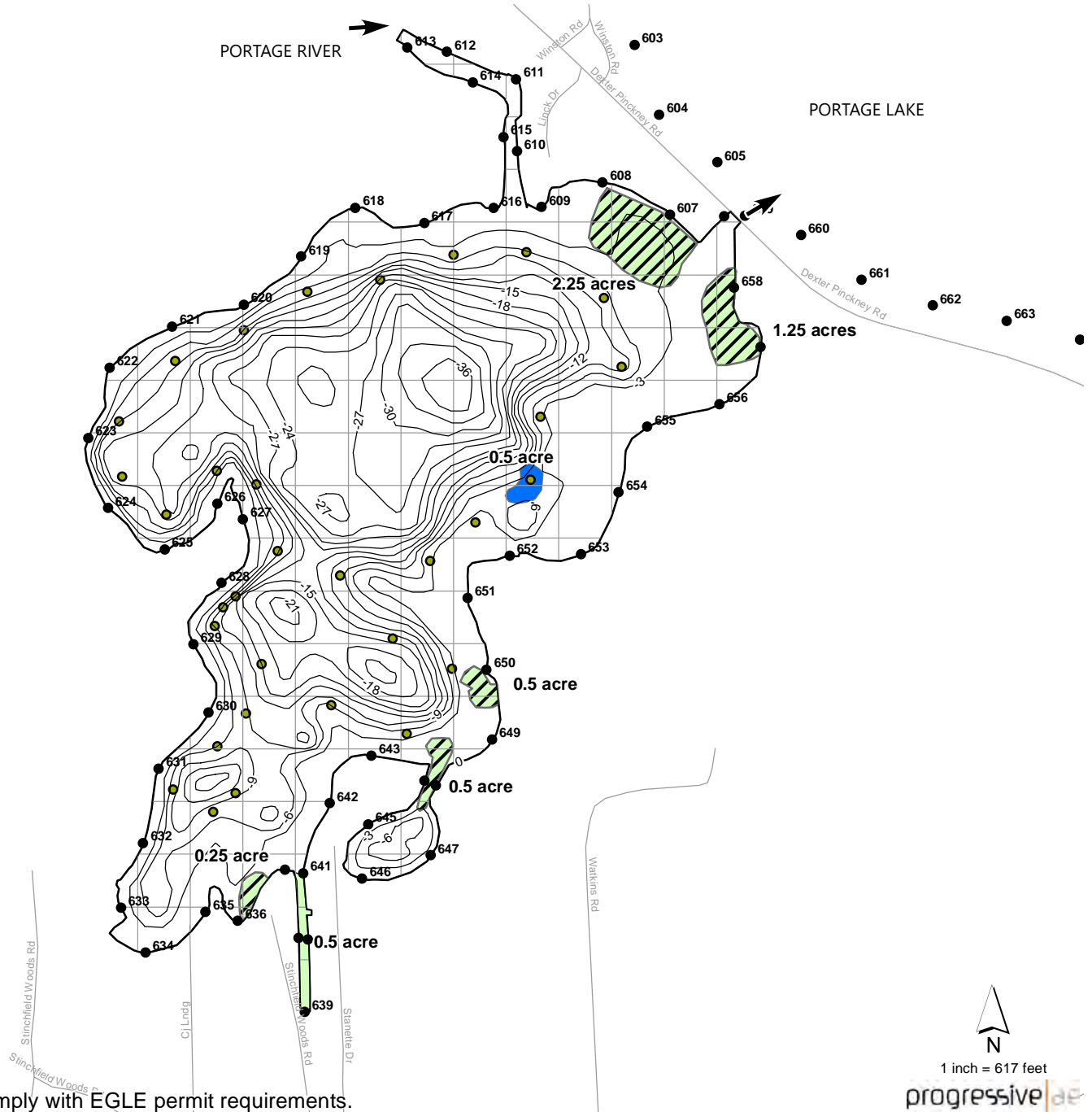

LAKE AREA = 98 ACRES
REVISION DATE: MARCH 2020

The applicator shall make adjustments, if needed, to comply with EGLE permit requirements.