

# How to cast your ballot using Verity Scan

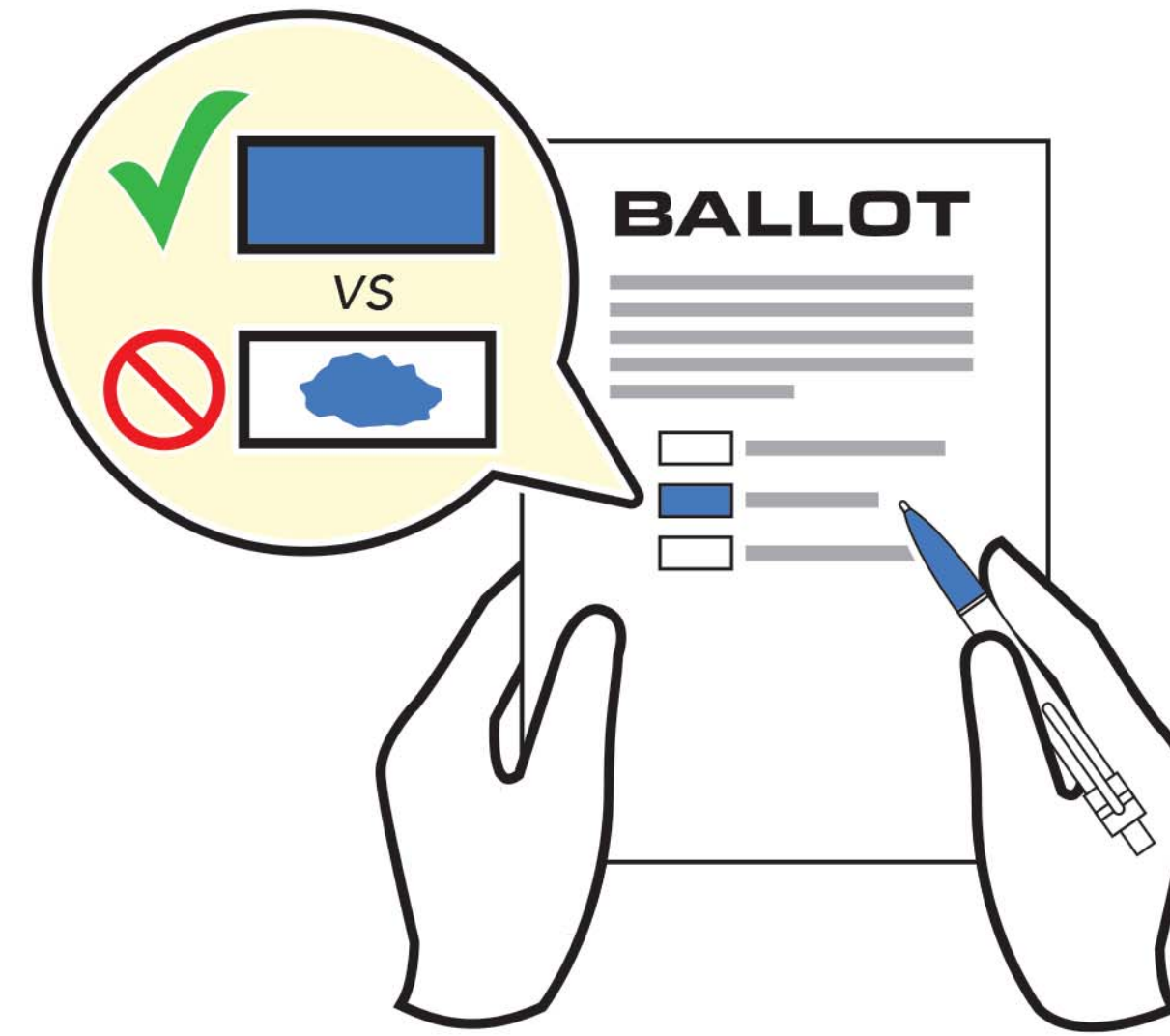

1

Mark your ballot in blue or black ink, *completely filling* the box next to each choice.\*



\* Alternatively, ask a poll worker for a ballot-marking device.

2

Review your ballot carefully to confirm your selections.

3

Cast your ballot by inserting it in the scanner.

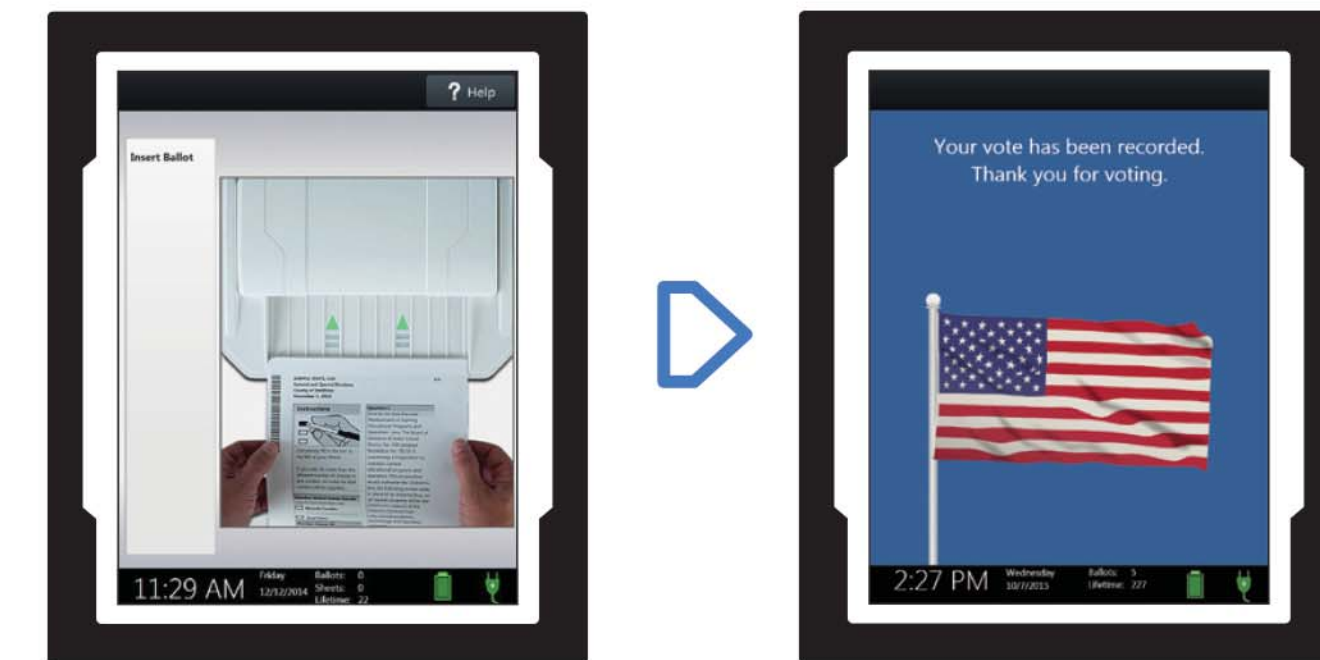

A waving American flag appears, indicating success!