

# BASELINE LAKE LIVINGSTON COUNTY, MICHIGAN JULY 30, 2019 HARVEST MAP

## Legend

 Harvesting = 2 acres of pondweeds, wild celery, and native milfoil

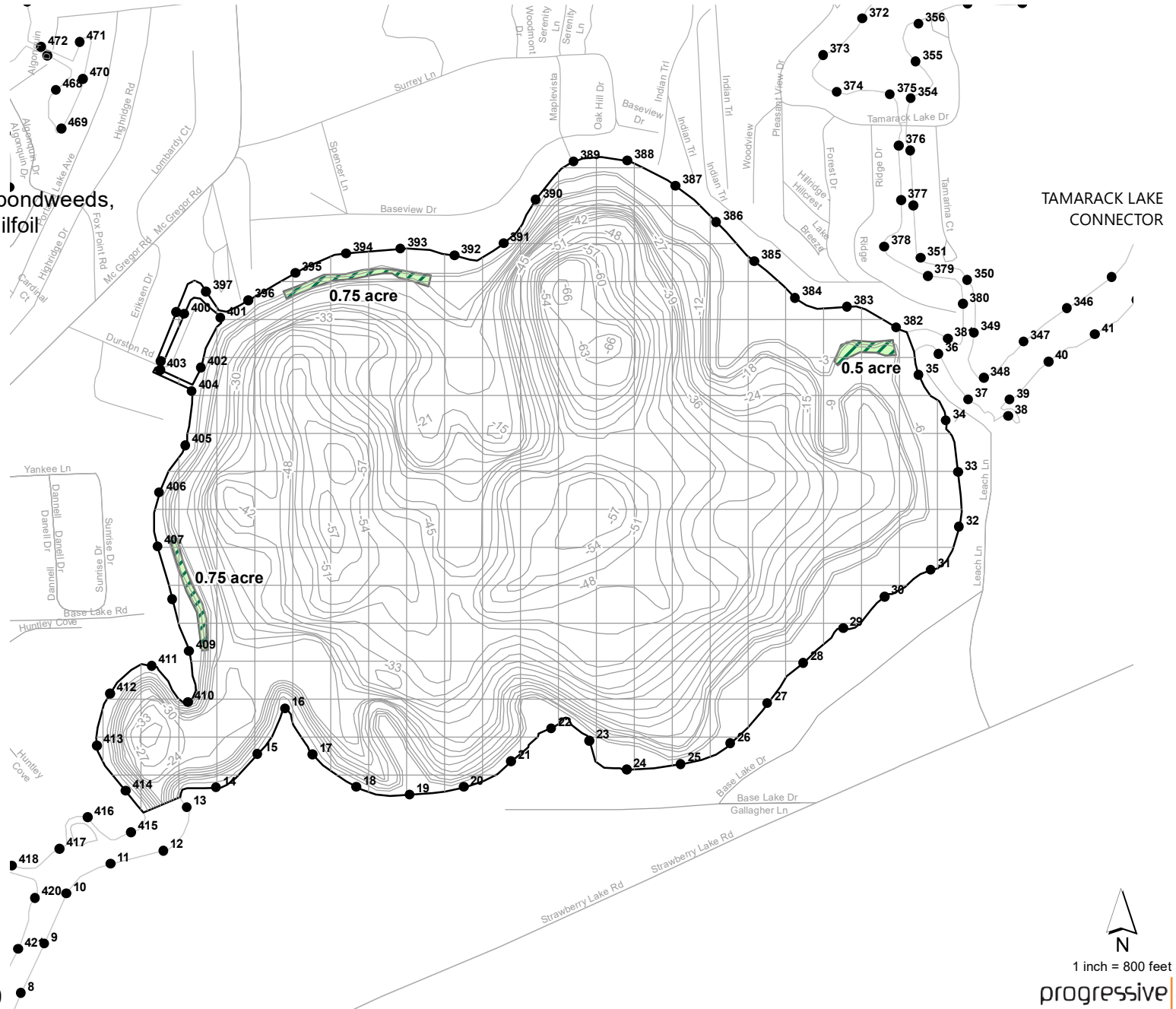

BASELINE PORTAGE CONNECTOR

LAKE AREA = 258 ACRES  
REVISION DATE: MAY, 2019



1 inch = 800 feet