





LITTLE PORTAGE LAKE LIVINGSTON COUNTY, MICHIGAN JULY 1, 2019 TREATMENT MAP

Legend

-  2,4-D Ester = 2.5 acres of non-native milfoil w/Navigate @ 150 lbs./acre
-  Clipper/Diquat = 1.5 acres of mixed exotics w/flumioxazin @ 100 ppb w/diquat-dibromide
-  Copper/Hydro = 8.5 acres of starry stonewort w/CuSO4/Hydrothol 191
-  Triclopyr Liquid = 0.75 acres of non-native milfoil w/Navitro liquid @ 4 gal./acre

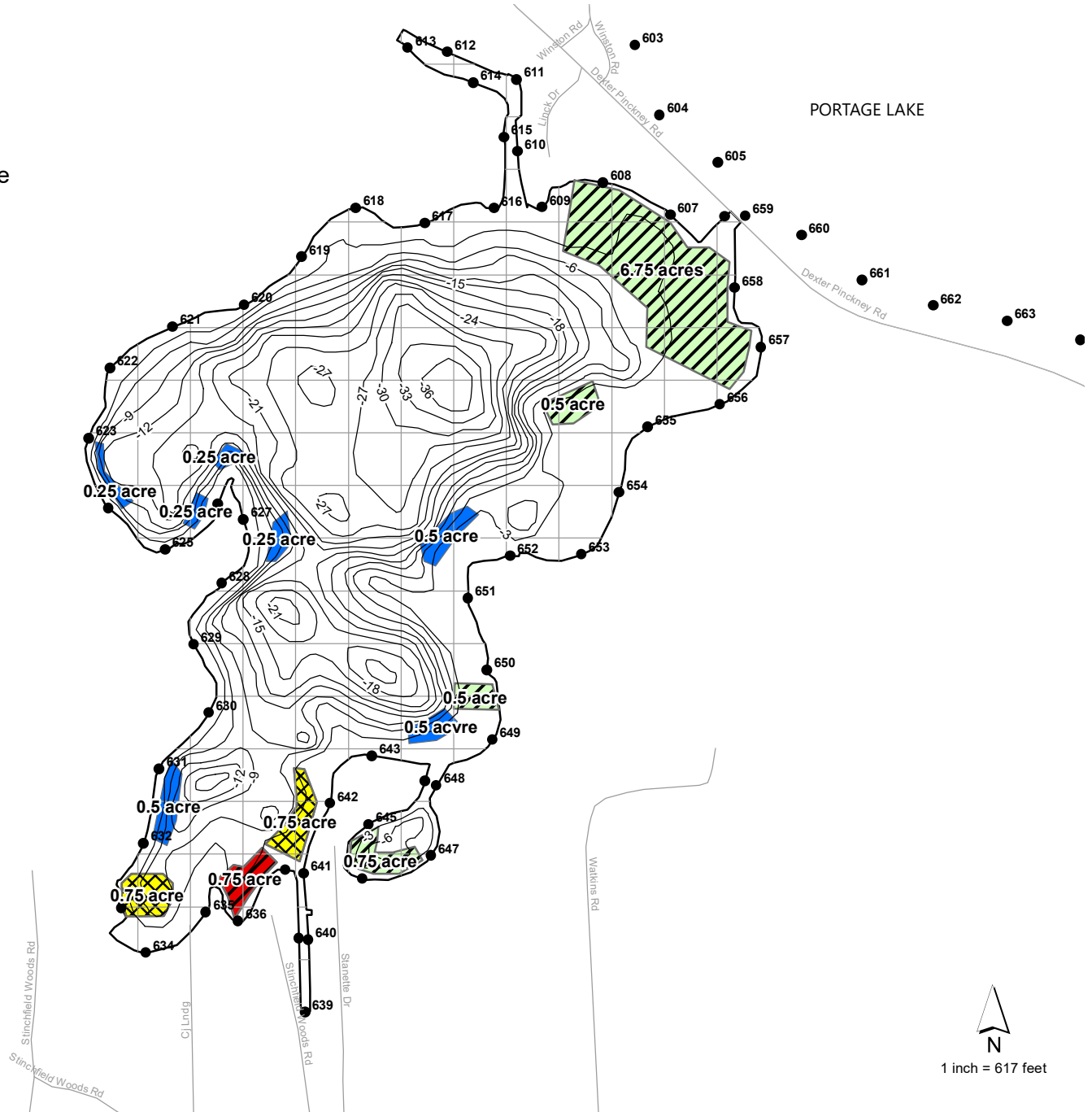

LAKE AREA = 98 ACRES
REVISION DATE: MAY, 2019