

LITTLE PORTAGE LAKE LIVINGSTON COUNTY, MICHIGAN MAY 22, 2019 TREATMENT MAP

Legend

- 2,4-D Ester = 0.5 acre of non-native milfoil w/Navigate @ 150 lbs./acre
- Clipper/Diquat = 2.5 acres of mixed exotics w/flumioxazin @ 100 ppb w/diquat-dibromide

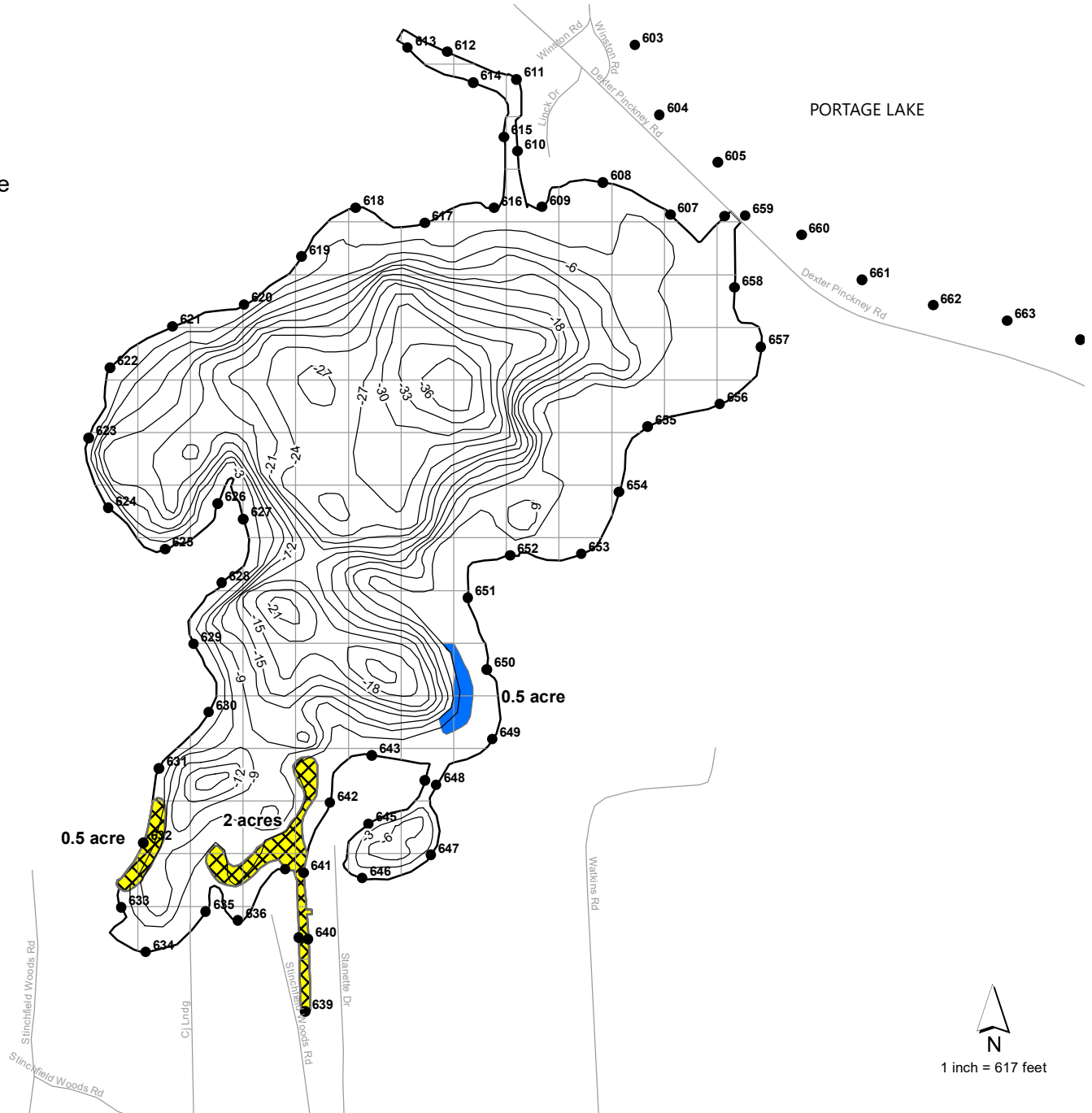

LAKE AREA = 98 ACRES
REVISION DATE: MAY, 2019